



Acreage: 65 **Acres**
Above grade: 2684 **ft2**



Thank you for your interest

Would you like to view the listing again online?

Scan the QR code to view the full listing, with detailed information, videos
and more on our website.



VISIT US 154B MILL ST, CREEMORE ON L0M 1G0

OFFICE 705.466.2115 | CELL 519.943.4403 | EMAIL info@suzannelawrence.ca

ROYAL LEPAGE RCR Realty, Brokerage. Independently Owned & Operated.



SUZANNE LAWRENCE
where town and country meet®

PRESENTS

Sable Hill Farm

627162 15 Sideroad, Mulmur



Notes

627162 15 Sideroad, Mulmur

Sable Hill Farm

A corner farm of 65 acres decorated with paddocks, barns, and riding ring on a quiet road with privacy & gorgeous vistas. Country kitchen with huge center island, separate dining room perched overlooking pond, cozy living areas. Perfect home for entertaining & watching the horses.



Area: 2684 **ft2**
Age: **65 years**
Lot size: **65 acres**



Highlights

Finished Area

This lovely log home has been beautifully maintained with upgrades throughout the years. A sizeable granite countertop kitchen island, spacious rooms, and views from every window makes this home a delight.



Property Size

Enjoy 65 acres of rolling hills and incredible views, decorated with a gorgeous pond, paddocks and beautiful barn.



Mulmur Township

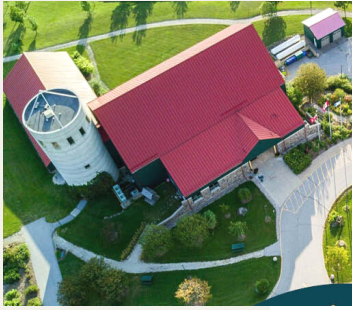

About Mulmur *"Follow your heart".*

Mulmur Township is considered a wee bit of heaven tucked away at the north-east corner of Dufferin County, about an hour's drive north-west of the City of Toronto. Mulmur straddles the famous Niagara Escarpment, a UNESCO World Biosphere Reserve. The escarpment itself consists of steep slopes and river valleys surrounded by extensive forests. Below it, Mulmur descends into gently rolling farmlands and rural areas.

Restaurants, Shopping, Art and Sports

Mulmur keeps you curious. Find local delicacies in our restaurants and farmers' markets, peruse unique shops and artisans' studios. Go horseback riding in Ontario's only 1200-acre dude ranch, enjoy fishing, hiking, biking downhill or Nordic skiing, snowshoeing and snowmobiling. After your day of exploring the breathtaking vistas, kick back and relax in our hidden paradise.

Schools

Primrose Elementary School is a rural JK to Gr.8 school located just north of the Primrose corner of Hwy 10 and Hwy 89. Students and staff enjoy a picturesque setting in the hills of Mulmur. Students who graduate from Primrose move on to **Centre Dufferin and District High School** in Shelburne. Both School Council are very active and supports a number of student activities throughout the year.

Would you like more information on Mulmur? Visit mulmur.ca, betterinmulmur.ca (a local initiative) or view suzannelawrence.ca/townships



Age of House

Built in 1957.



Floorplans

Maps presented as per the referred websites and is not to be used as a legal description of the property. It is for information purposes only and may not represent actual or current conditions.

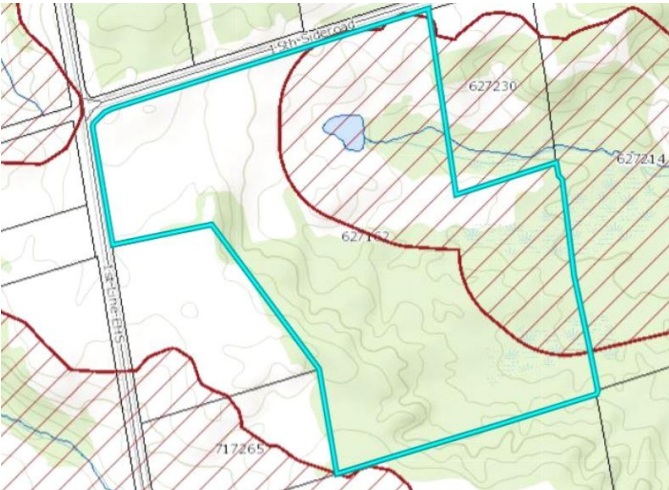

MAP PRESENTED AS PER NVCA

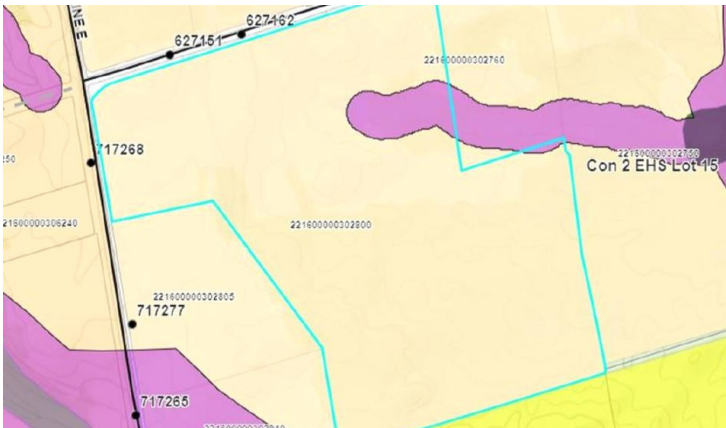

MAP PRESENTED AS PER MULMUR TOWNSHIP





MAIN LEVEL



LOWER LEVEL

