

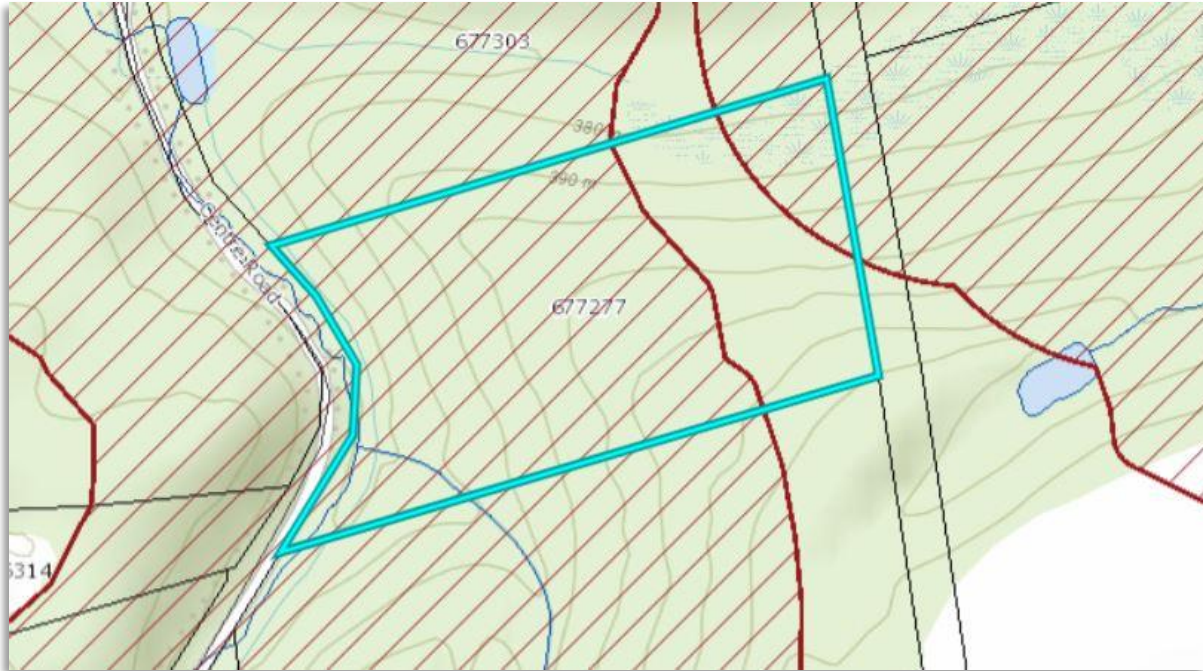

Nottawasaga Valley
Conservation
Authority

677277 Centre Rd, Mulmur



Aerial map presented as per NVCA website and is not to be used as a legal description of the property. It is for information purposes only and may not represent actual or current conditions.

Base Mapping <ul style="list-style-type: none"><input type="checkbox"/> NVCA Jurisdiction<input type="checkbox"/> Lower Tier Jurisdiction<input type="checkbox"/> Dufferin County/Grey County Assessment Parcels	Nvca Regulated Areas <ul style="list-style-type: none"><input checked="" type="checkbox"/> NVCA Regulated Area	Building Type <ul style="list-style-type: none"><input type="checkbox"/> Building Type
Topographic Basemap Features <ul style="list-style-type: none"><input type="checkbox"/> Jurisdictional Border<input type="checkbox"/> First Nations Territory<input type="checkbox"/> Trail<input type="checkbox"/> Railway<input type="checkbox"/> Urban Area<input type="checkbox"/> Elevation<input type="checkbox"/> Wooded Area	Transportation (Roads) <p>Transportation (Roads) > 1:15000</p> <ul style="list-style-type: none"><input type="checkbox"/> Highway<input type="checkbox"/> Major Road<input type="checkbox"/> Local Road<input type="checkbox"/> Private, Unassumed and Seasonal Road <p>Transportation (Roads) < 1:15000</p> <ul style="list-style-type: none"><input type="checkbox"/> Highway<input type="checkbox"/> Major Road<input type="checkbox"/> Local Road<input type="checkbox"/> Private, Unassumed and Seasonal Road	Parcels <ul style="list-style-type: none"><input type="checkbox"/> Assessment Parcel<input type="checkbox"/> Ownership Parcel
Water Features <ul style="list-style-type: none"><input type="checkbox"/> River, Stream or Creek<input type="checkbox"/> Lake, Pond, River or Stream<input type="checkbox"/> Wetland		Land Type <ul style="list-style-type: none"><input type="checkbox"/> Airport<input type="checkbox"/> Cemetery<input type="checkbox"/> Commercial<input type="checkbox"/> Beach<input type="checkbox"/> Emergency Service<input type="checkbox"/> Education<input type="checkbox"/> Golf Course<input type="checkbox"/> Health Service<input type="checkbox"/> Municipal Park<input type="checkbox"/> Provincial Park<input type="checkbox"/> Industrial<input type="checkbox"/> Military